

# DISAPPEARING PINWHEEL

This block can be assembled to create a "Churn Dash" block or a "Shoo Fly" block with a pinwheel in the center, depending on the way the nine squares are positioned. The unfinished block measures 11 1/2" square.

For one block you will need two contrasting 9 1/2" squares.

1. Place two (2) 9 1/2" squares, right sides together. Sew a 1/4" seam around the outside edges (Fig 1).

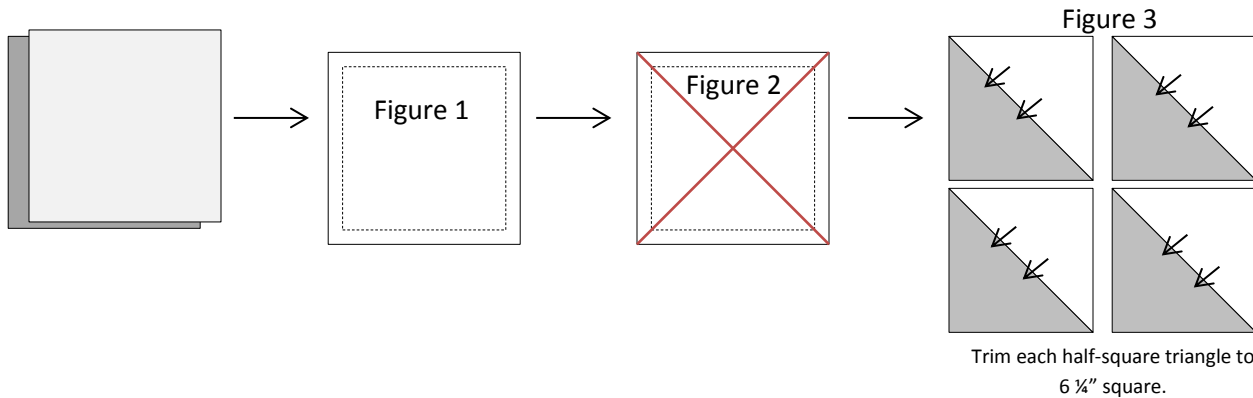

2. Cut on both diagonals (red lines) creating four (4) half-square triangles (Fig 2). Press open toward the darker fabric (Fig 3).
3. Trim the half-square triangles to 6 1/4" square (Fig 3). (They should be very close to that measurement.)
4. Arrange the four (4) half square triangles in a pinwheel design and sew together using a 1/4" seam creating a 12" pinwheel block. (Fig 4)

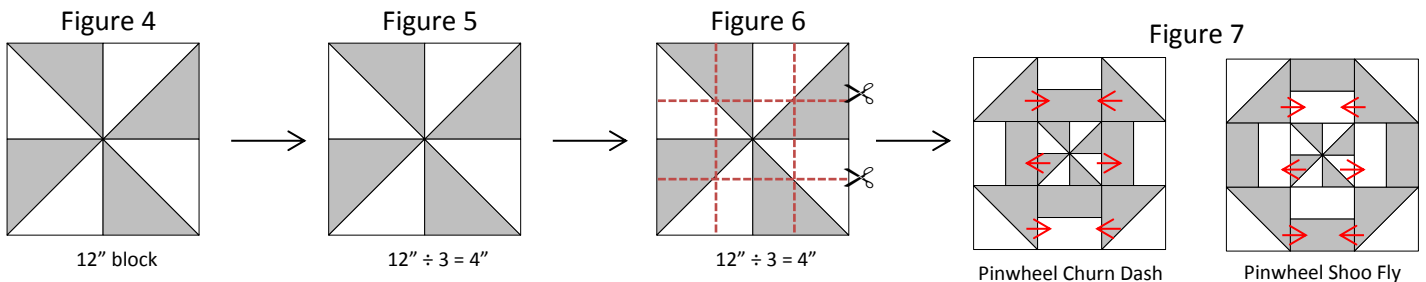

5. Divide your block measurement by 3 ( $12 \div 3 = 4''$ ). If your block does not measure 12" use the measurement of your block and divide that number by 3. Then, divide that measurement by 2 ( $4'' \div 2 = 2''$ ). This will give you your cutting measurement on each side of your center seam (vertically and horizontally).
6. For a block that measures 12", cut 2" on each side of the middle seam, both horizontally and vertically (Red dashed lines in Fig 6).
7. Flip squares as pictured to create either a Pinwheel Churn Dash or Pinwheel Shoo Fly block with a pinwheel in the center (Fig 7).
8. To assemble block, first sew squares together in rows of three and then sew the rows together. Press inner row seams away from center square and outer row seams toward center square. (Red arrows).
9. Unfinished block size is 11". Blocks can be created with a light or dark Pinwheel Churn Dash or Pinwheel Shoo Fly depending on how the individual squares are positioned.

